



# DESIGN PRESENTATION MIDDLE/HIGH SCHOOL– INTERIOR RENOVATIONS

Construction Document Phase  
October 26, 2020

# FOR TONIGHT



- Overall Project Update
- Original Referendum Scope and Evolution
- Long Term Facilities and Maintenance Scope
- Construction Document Review
  - Plans, Axonometries, Materials, and Renderings
- Timeline
- Next Steps

# MAJOR PROJECT LIST

| NAME                                   | LOCATION                                 | CONSTRUCTION START                             | CONSTRUCTION DURATION |
|--|--|--|-----------------------|
| LAKE RIPLEY SITE PROJECT               | Lake Ripley Elementary School            | Complete                                       | 2-3 Months            |
| BLEACHER REPLACEMENT                   | Litchfield Middle School                 | Complete                                       | 1 Week                |
| KITCHEN, CAFETERIA and ADMINISTRATION  | Lake Ripley Elementary School            | October 2020                                   | 5-6 Months            |
| LAKE RIPLEY INTERIOR RENOVATIONS       | Lake Ripley Elementary School            | Anticipated June 2021<br>Anticipated June 2022 | 6 Months (2 Phases)   |
| HIGH SCHOOL MIDDLE SCHOOL RENOVATIONS  | Litchfield High School and Middle School | Anticipated June 2021<br>Anticipated June 2022 | 6 Months (2 Phases)   |
| HIGH SCHOOL MIDDLE SCHOOL SITE PROJECT | Litchfield High School and Middle School | Anticipated June 2022                          | 3 Months              |

# LMHS - PLAN EVOLUTION

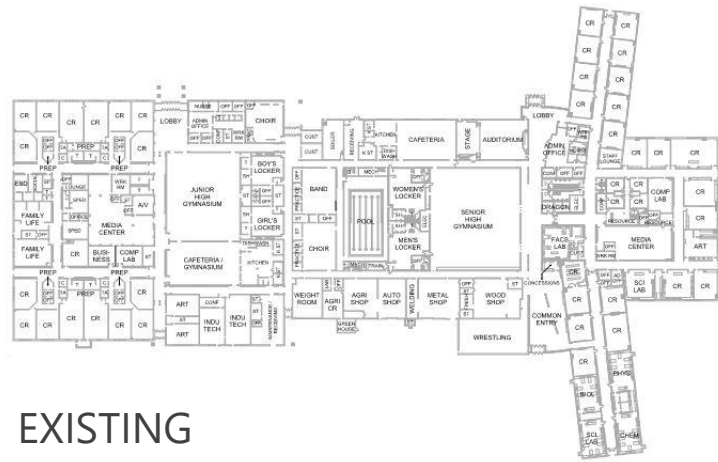

EXISTING

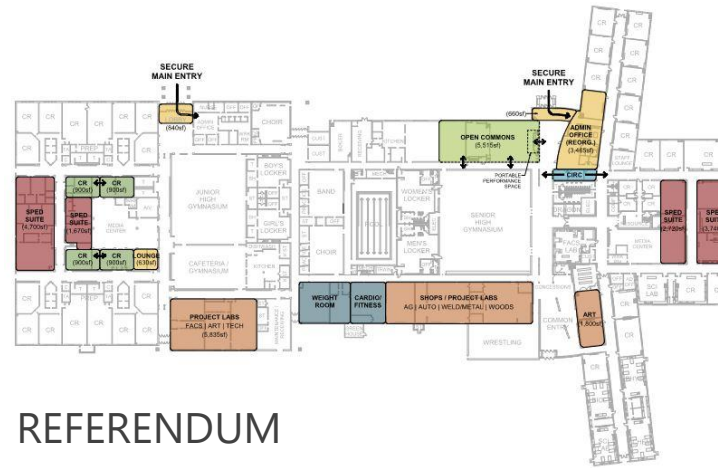

REFERENDUM

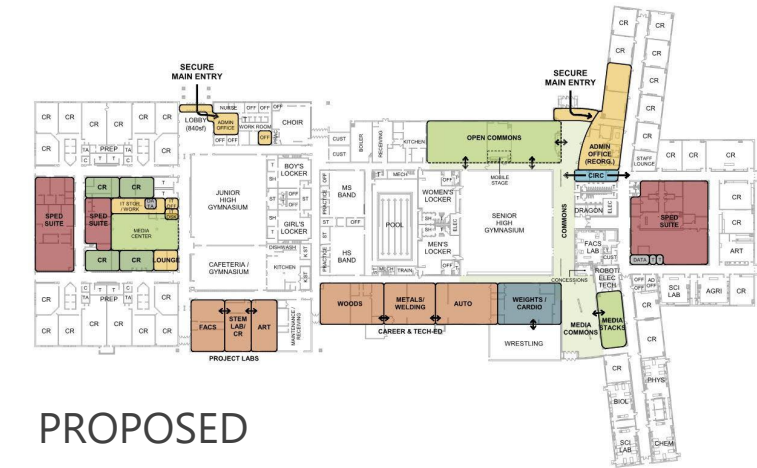

PROPOSED



## BASE PROJECT SCOPE

- LMHS – Improve Secure Main Entries
- LMHS – Reorganize SPED Suites
- LMS – Additional Classrooms
- LMS – Project Labs Spaces (Art, FACS, STEM)
- LHS – Commons
- LHS – Career & Tech-Ed
- LHS – Weights & Cardio



## UPDATED PROJECT SCOPE

- LMHS – Security Upgrades & Reorganize Admin Offices
- LMHS – SPED Suites: designated spaces as part of the larger school
- LMS – Classrooms similar to existing but improved
- LMS – Project Labs: complimentary programs
- LHS – Commons: cafeteria / performances / educational setting
- LHS – Career & Tech-Ed: contiguous w/MS project labs
- LHS – Weights & Cardio adjacent to Gym & Wrestling

# LMS - LONG-TERM FACILITIES MAINTENANCE



## **Controlled Entrance Modifications – Improve Security**

- New Main Doors & Exterior Door Enhancements | Mass Notification System+ | Reconfigure Entrance | Radio / Booster System

## **Mechanical / Electrical**

- Ceiling and Light (LED) Upgrade

## **Interior Improvements**

- Flooring Replacements | Interior Fire Door / Event Door Replacements | Student Hallway Lockers | Locker Rooms – Shower Area Upgrades | Restroom Upgrades

## **Exterior – Building Envelop Improvements**

- Tuckpointing, Caulking, Brick Repair

## **Other / Miscellaneous Improvements**

- Water Service to Receiving Area | Greenhouse Removal | Food Service / Kitchen Equipment

# LHS - LONG-TERM FACILITIES MAINTENANCE



## **Controlled Entrance Modifications – Improve Security**

- New Main Door & Exterior Door Enhancements | Mass Notification System+ | Reconfigure Entrance | Radio / Booster System

## **Mechanical / Electrical**

- Ventilation Replacements (VUV Replacements) | Ceiling and Light (LED) Upgrade

## **Interior Improvements**

- Interior Fire Door / Event Door Replacements | Gym Scoreboards

## **Exterior – Building Envelop Improvements**

- Tuckpointing, Caulking, Brick Repair | Shop Area (windows and doors)

## **Exterior – Site Improvements**

- Sidewalks (Middle & High School)

## **Other / Miscellaneous Improvements**

- Greenhouse Removal | Walk-in Freezer | Track/Football – New LED Lighting



# LMHS – PROPOSED PLAN

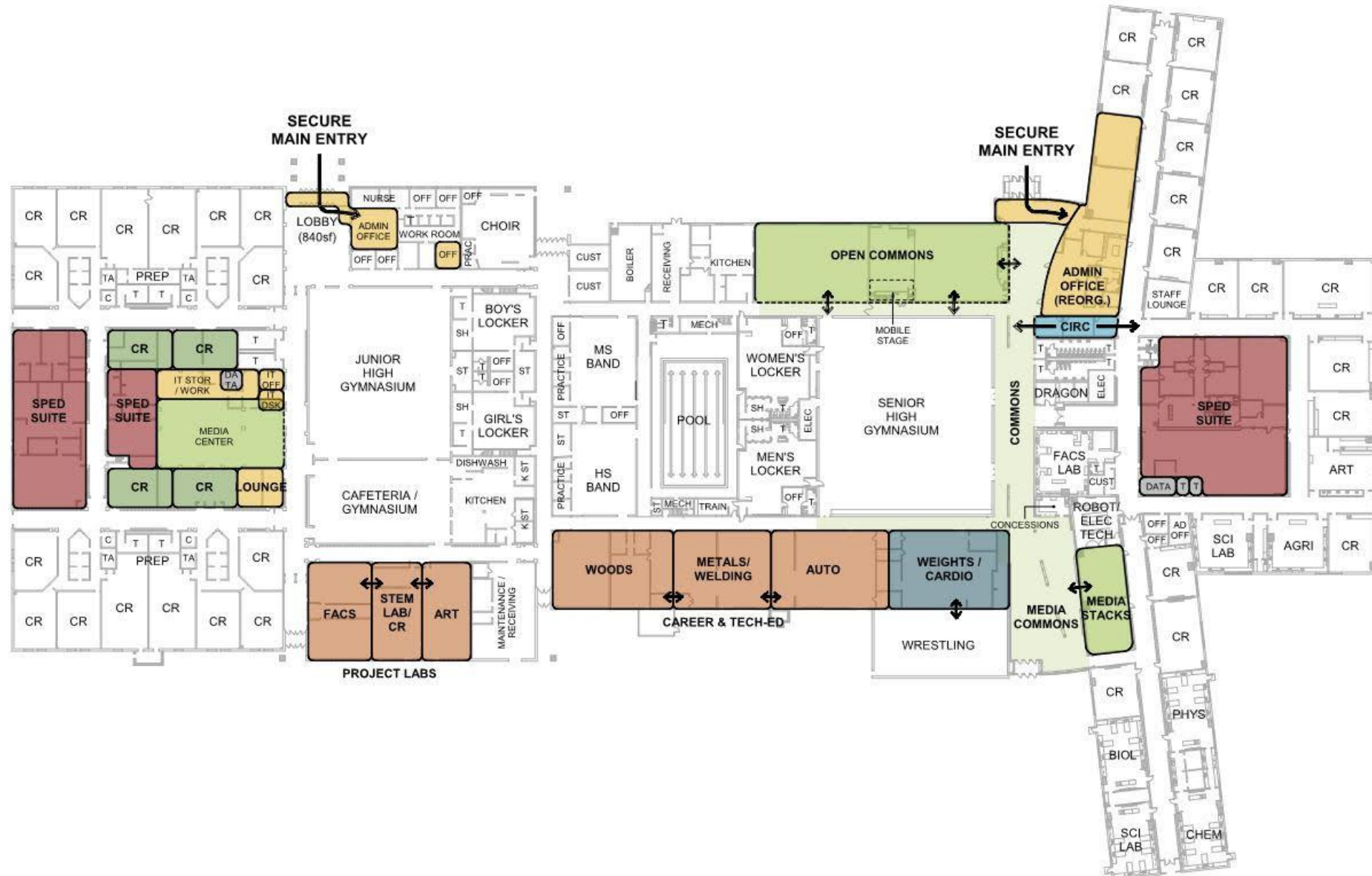

# LMS – USER GROUP PLAN – SECURE VESTIBULE/ADMIN

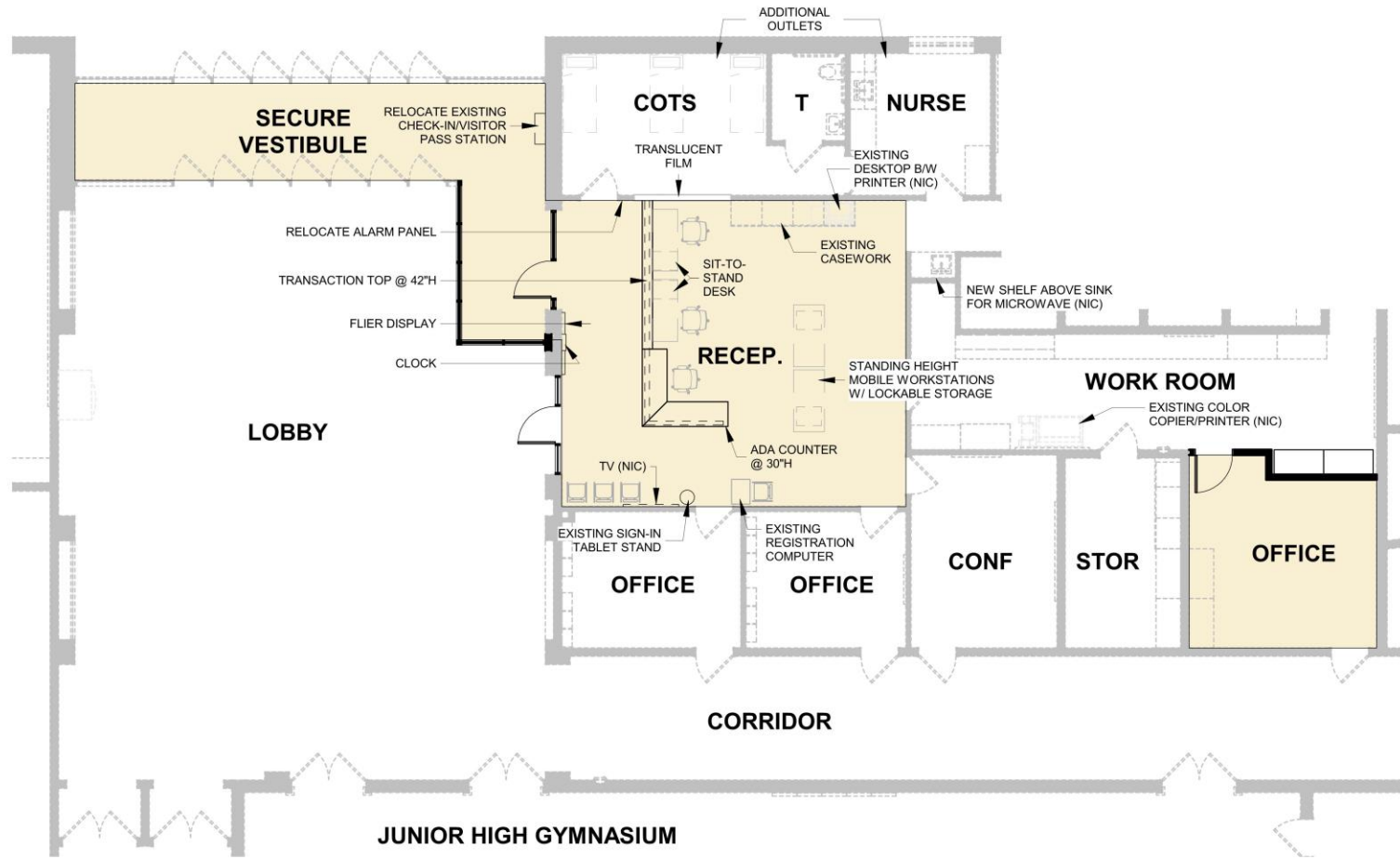

Secure Vestibule & Admin Office





# LMS – USER GROUP PLAN – SPECIAL EDUCATION

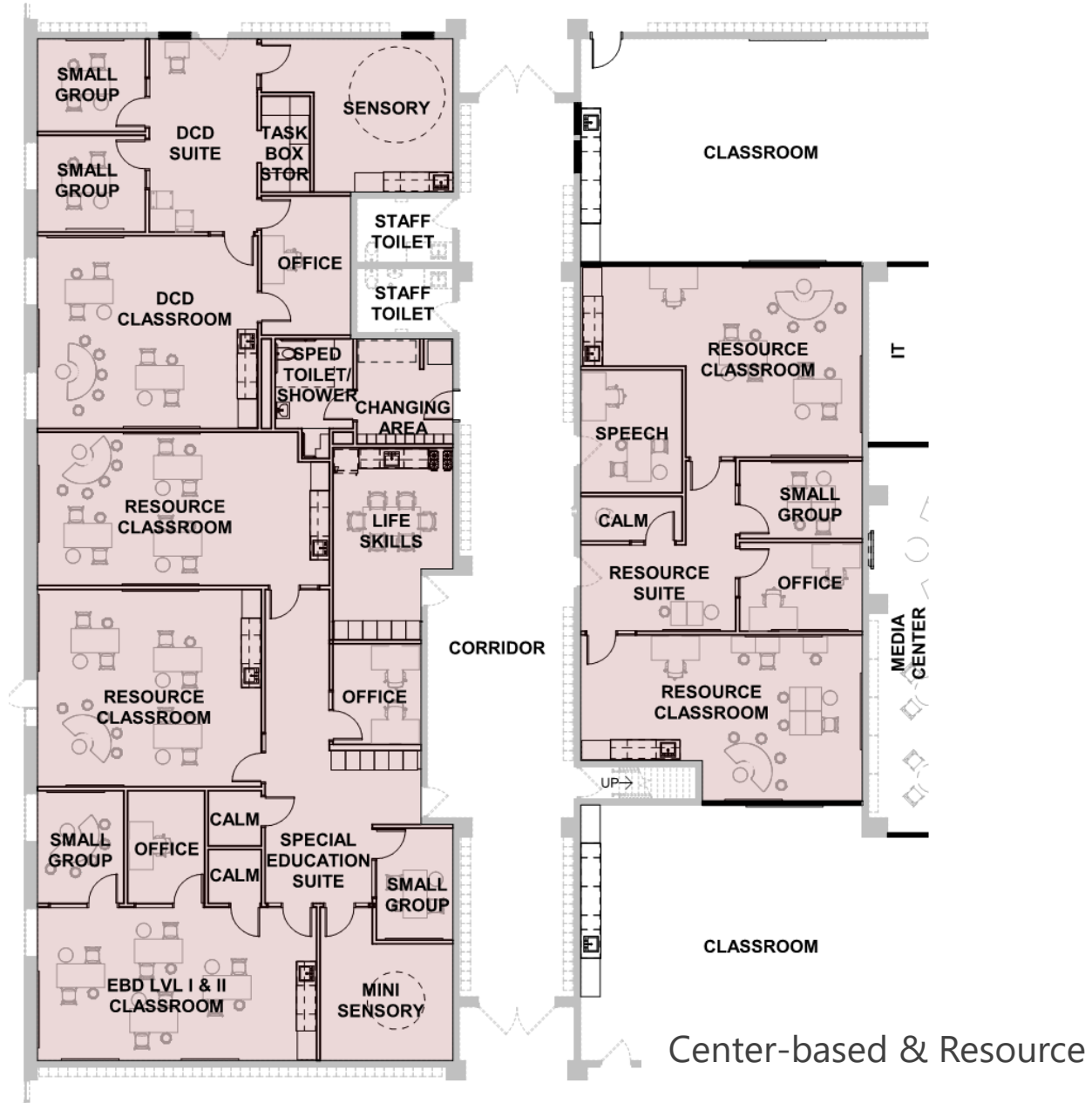
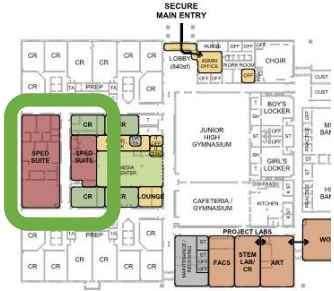

# LMS – USER GROUP PLAN – FACS/ART/STEM

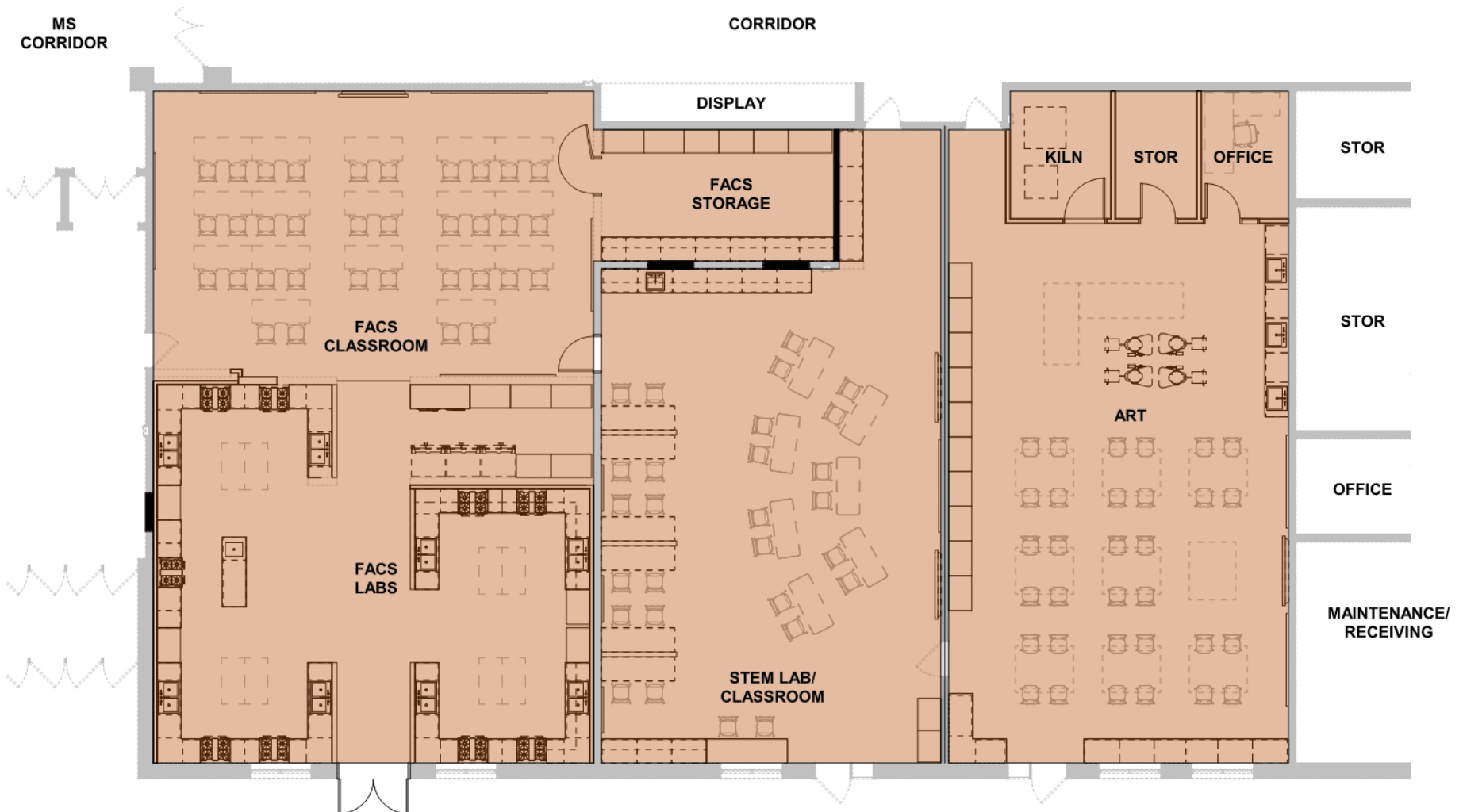
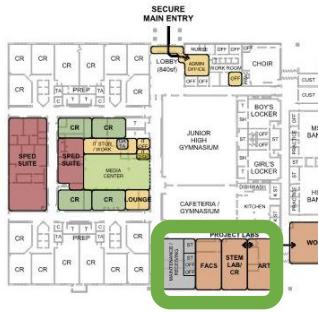

FACS / Art / STEM



# LMS – USER GROUP PLAN – MEDIA CENTER

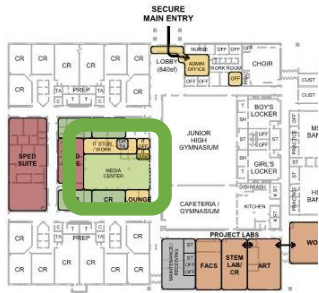

Media Center & District IT



# LMS – MEDIA CENTER

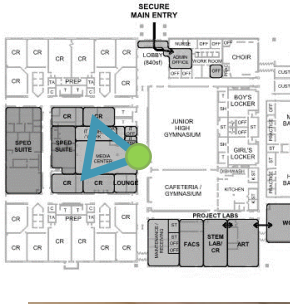

Media Center & IT Help Desk



# LMS- MEDIA CENTER



Media Center

# LHS – USER GROUP PLAN – SECURE VESTIBULE/ADMIN

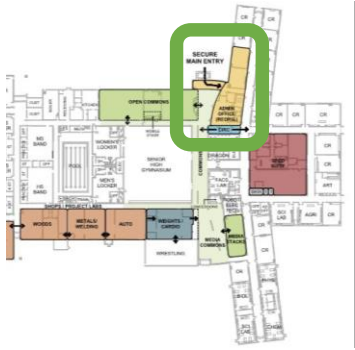

Secure Entry & Admin Office





# LHS – USER GROUP PLAN – SPECIAL EDUCATION

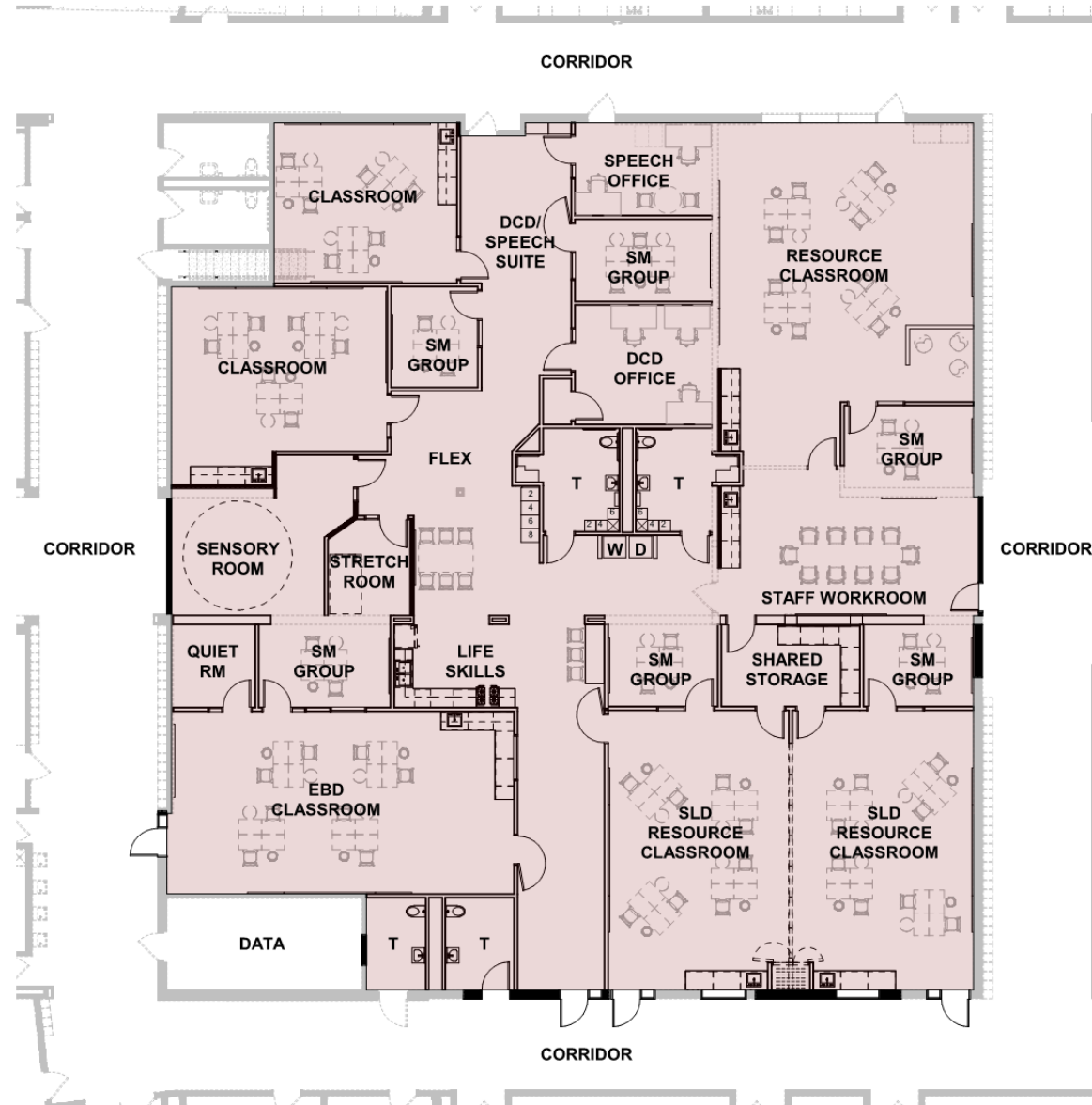
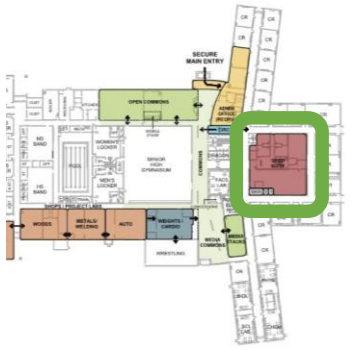

Center-based & Resource



# LHS – USER GROUP PLAN – CAREER AND TECH ED

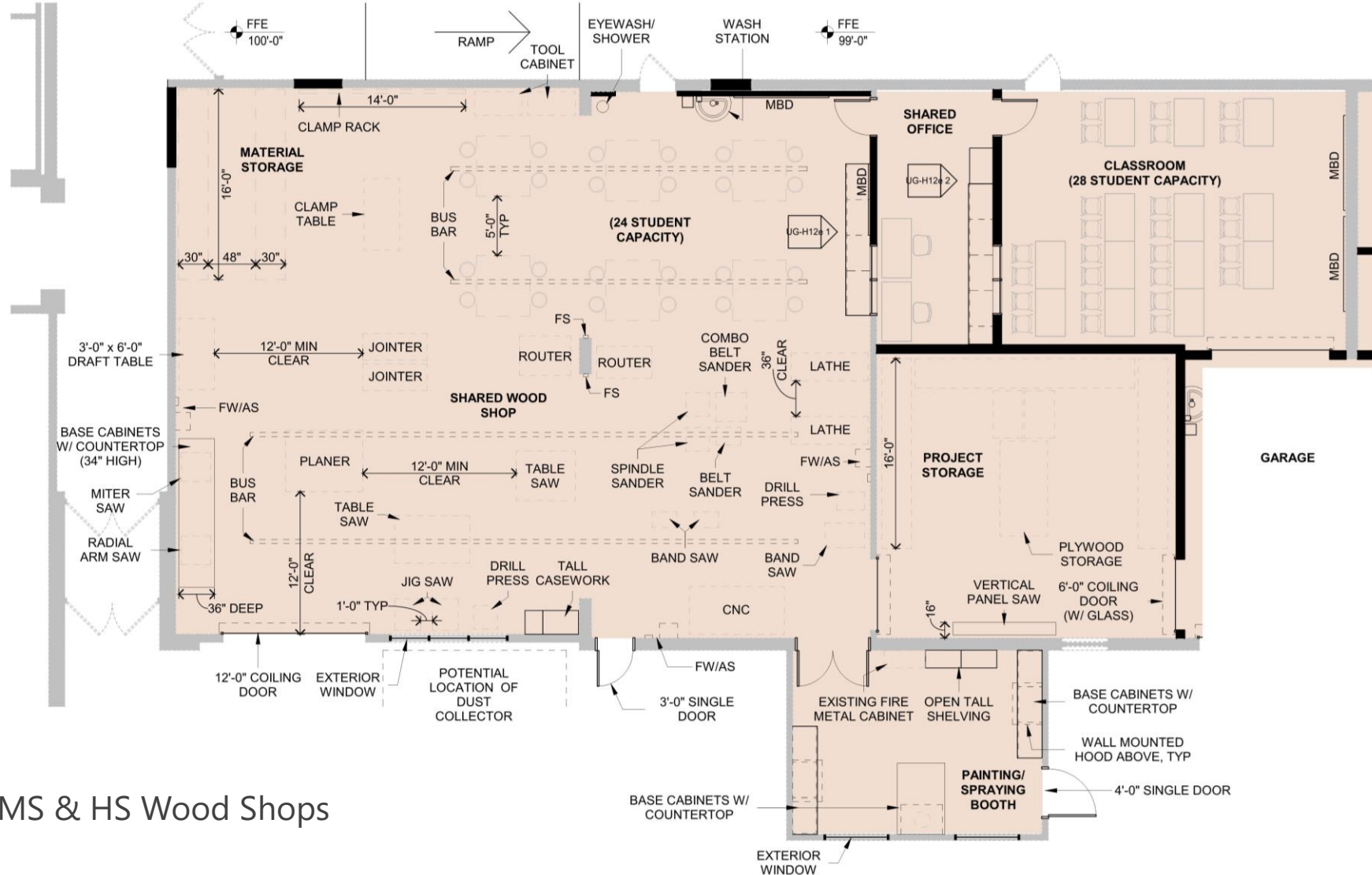
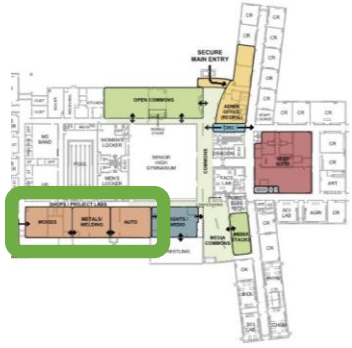

MS & HS Wood Shops



# LHS – USER GROUP PLAN – CAREER AND TECH ED

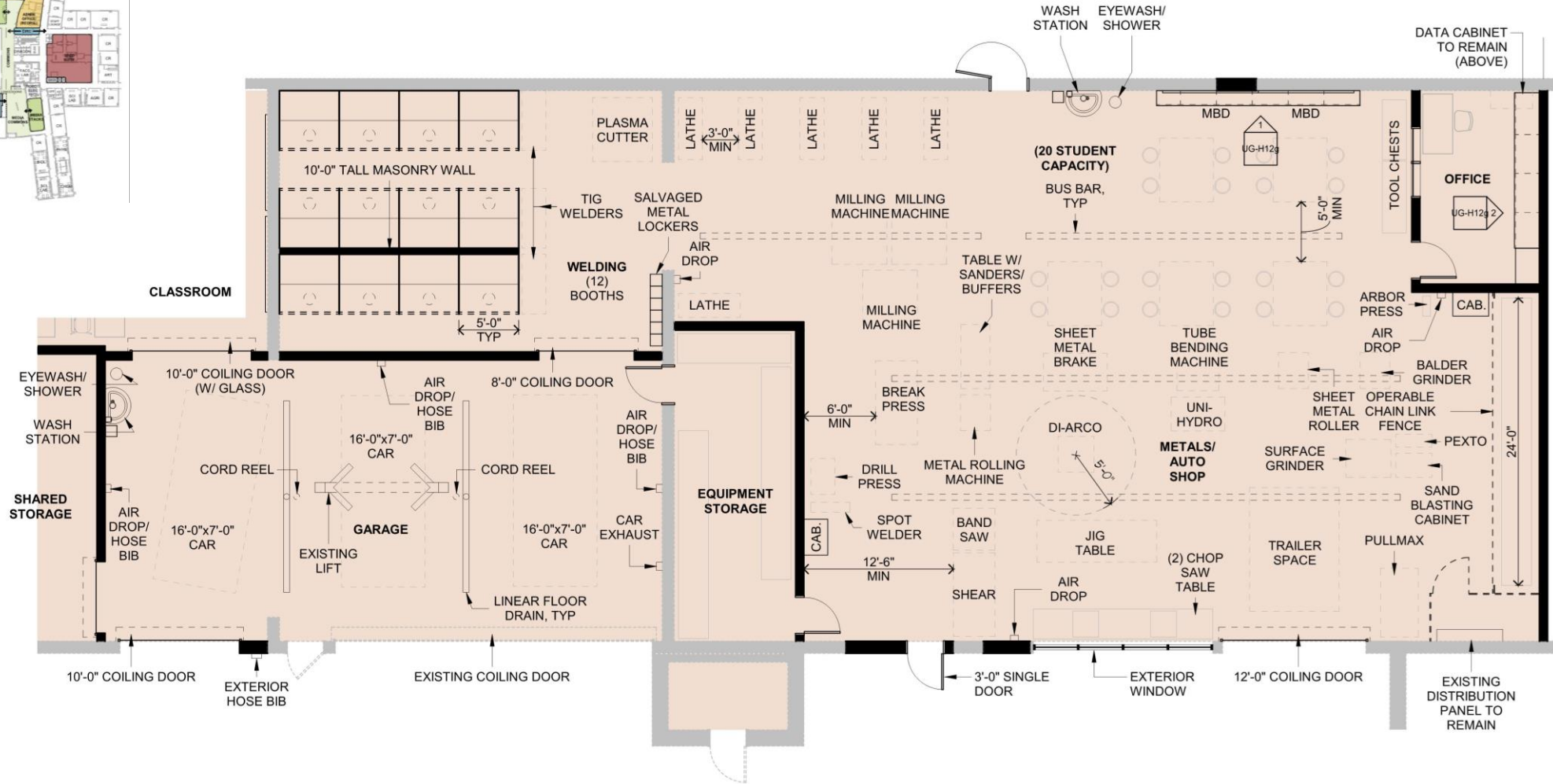
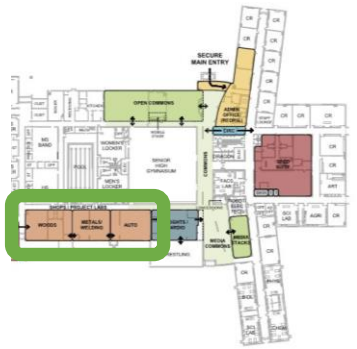

Metals, Welding & Auto



# LHS – USER GROUP PLAN – WEIGHTS & CARDIO

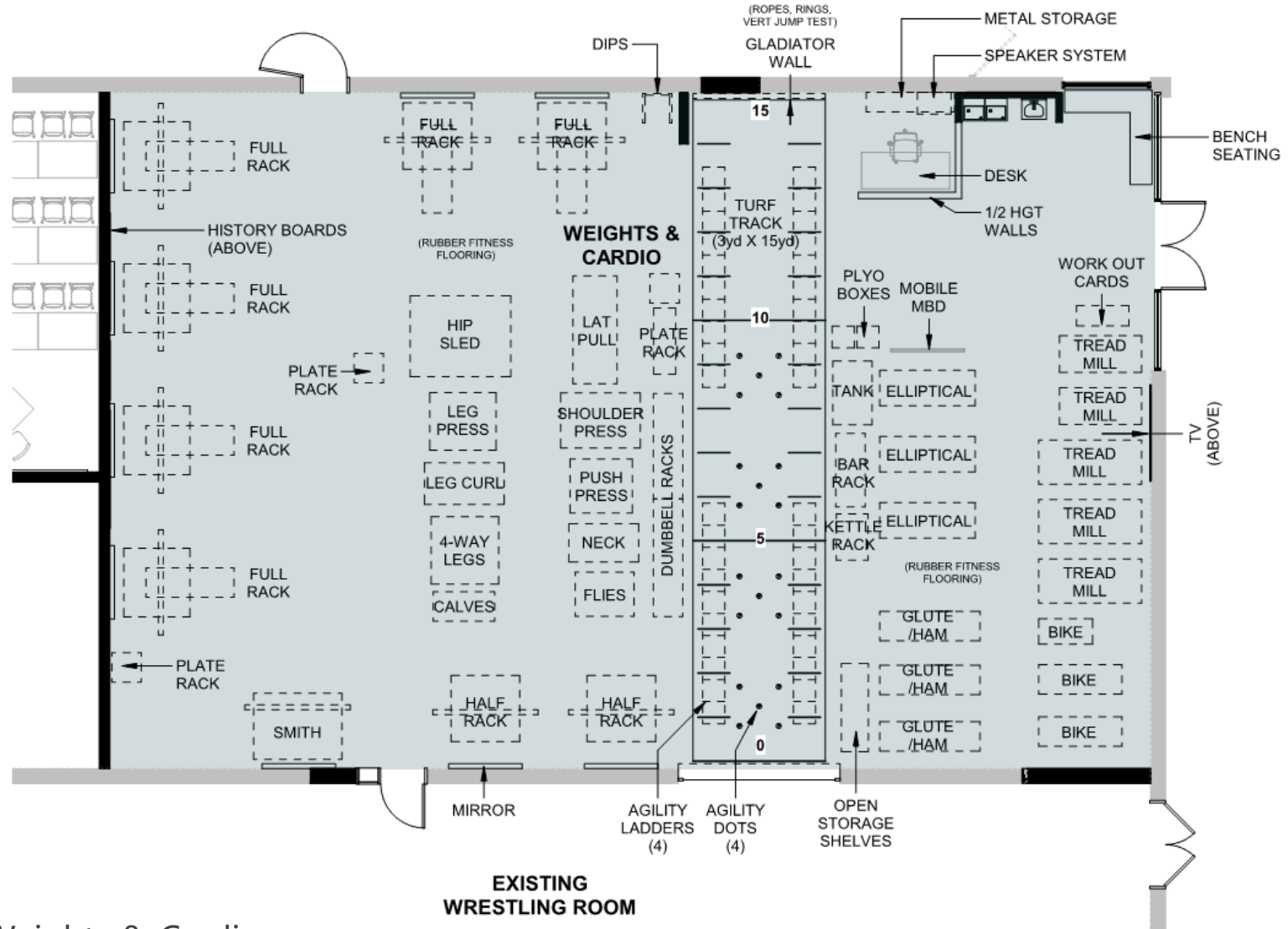
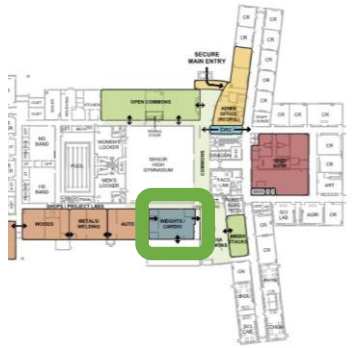

Weights & Cardio



# LHS – USER GROUP PLAN – MEDIA CENTER



Media Stacks, Commons, & IT





# LHS – USER GROUP PLAN – COMMONS

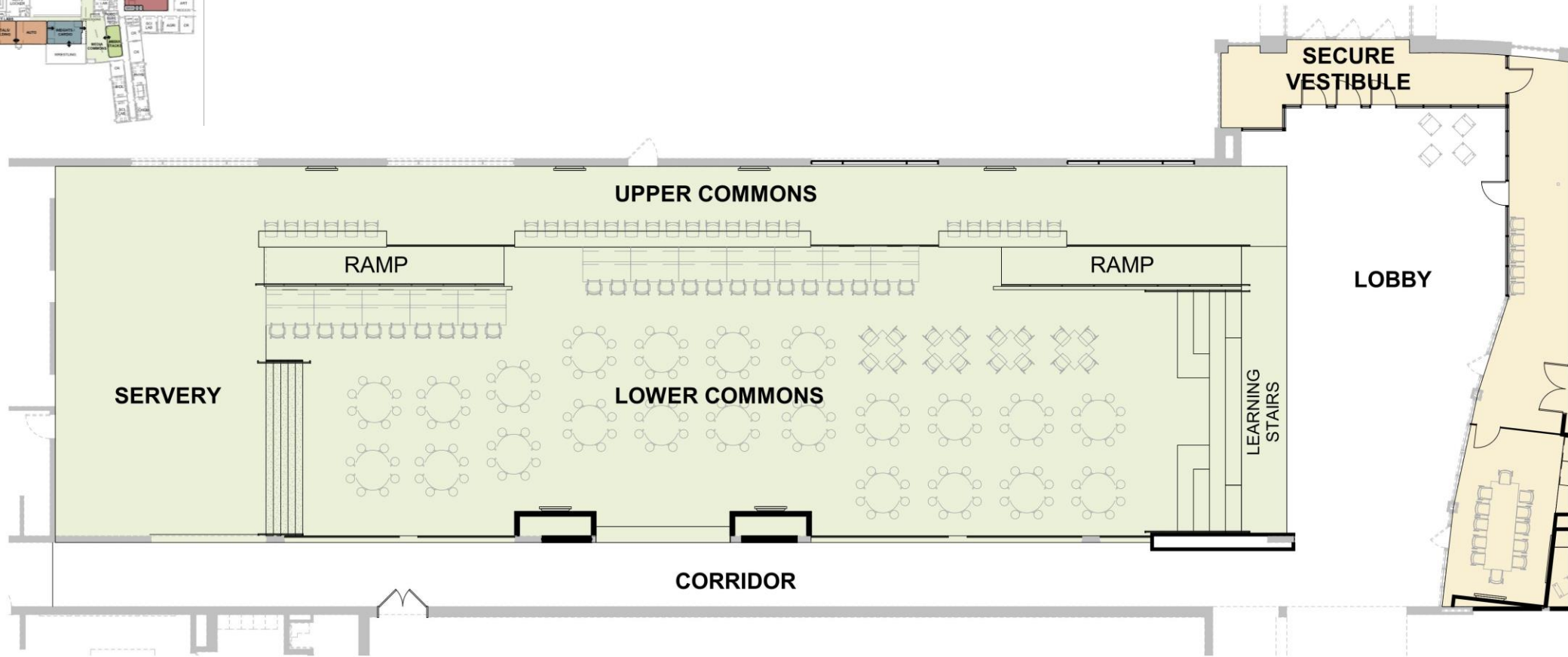
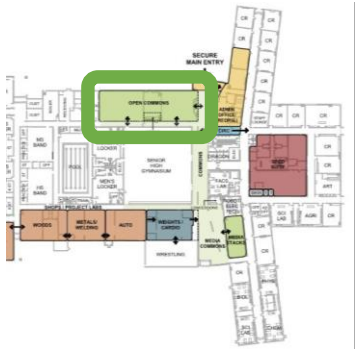

Commons – Cafeteria Layout





# LHS – USER GROUP PLAN – COMMONS

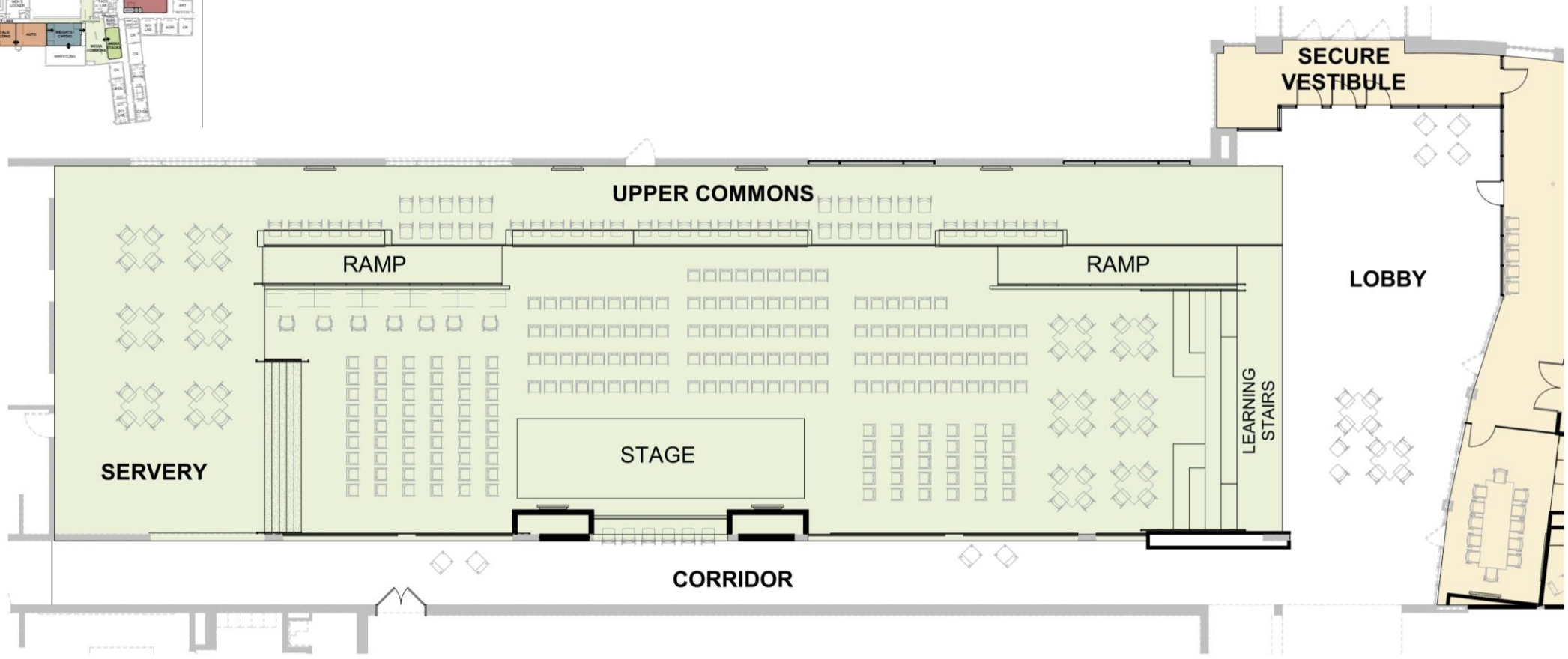
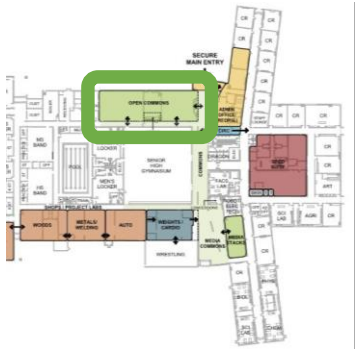

Commons – Performance Layout



# LHS – COMMONS ZONES

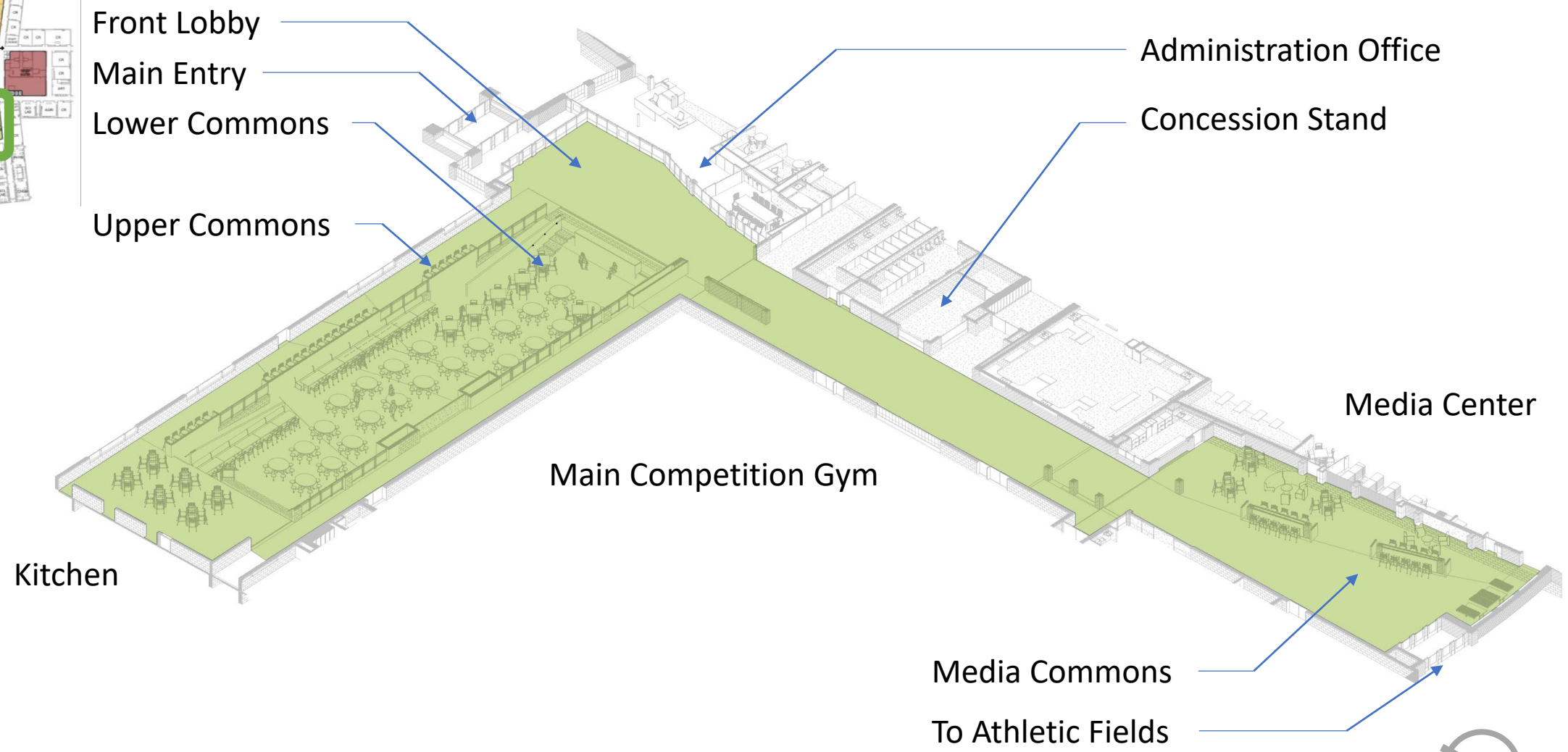
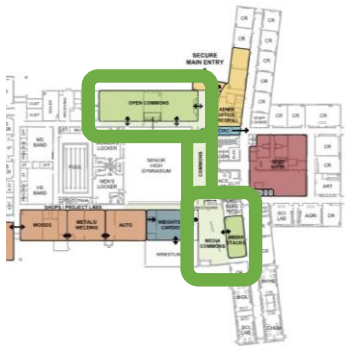

Front Lobby

Main Entry

Lower Commons

Upper Commons

Kitchen

Main Competition Gym

Administration Office

Concession Stand

Media Center

Media Commons

To Athletic Fields



# LMHS - MATERIALS



TILE

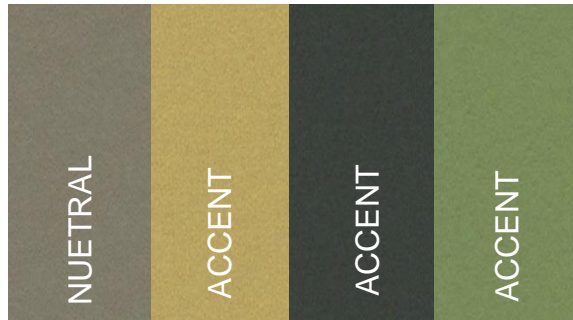

TACK WALL

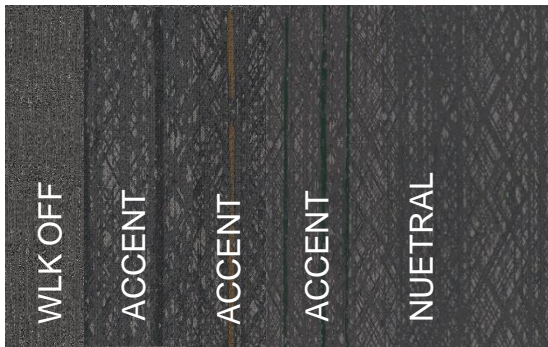

RESILIENT CARPET TILE



TERRAZZO

## NEW MATERIALS



PAINT

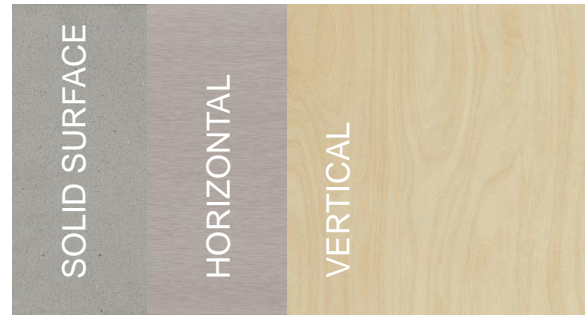

CASEWORK



LVT

## EXISTING MATERIALS



EXISTING DOORS



EXISTING BRICK



EXISTING BLOCK



EXISTING VCT



EXISTING



# LHS – COMMONS



Commons at Main Entrance



# LHS – USER GROUP PLAN – COMMONS/CAFETERIA



Commons at Servery



# LHS – USER GROUP PLAN – COMMONS/CAFETERIA



Learning Stairs at Commons



# LHS – USER GROUP PLAN – MEDIA CENTER



Media Commons

# Project Timeline

- Schematic / Design Development Design: April 2020-June 2020
- Construction Documents: July 2020 – October 2020
- Bidding: November 2020 – December 2020
- Construction starts: June 2021
- Project Complete: September 2022

# Next Steps



## / CONSTRUCTION

Lake Ripley Kitchen and Cafeteria Addition

## / BID DOCUMENTS

Middle School/High School Interior Renovations

Middle School/High School Site Renovations

## / DESIGN DEVELOPEMENT

Middle School/High School Site Renovations





**Q&A**

